

Hydraulic disc brake

i Series Assembly instruction

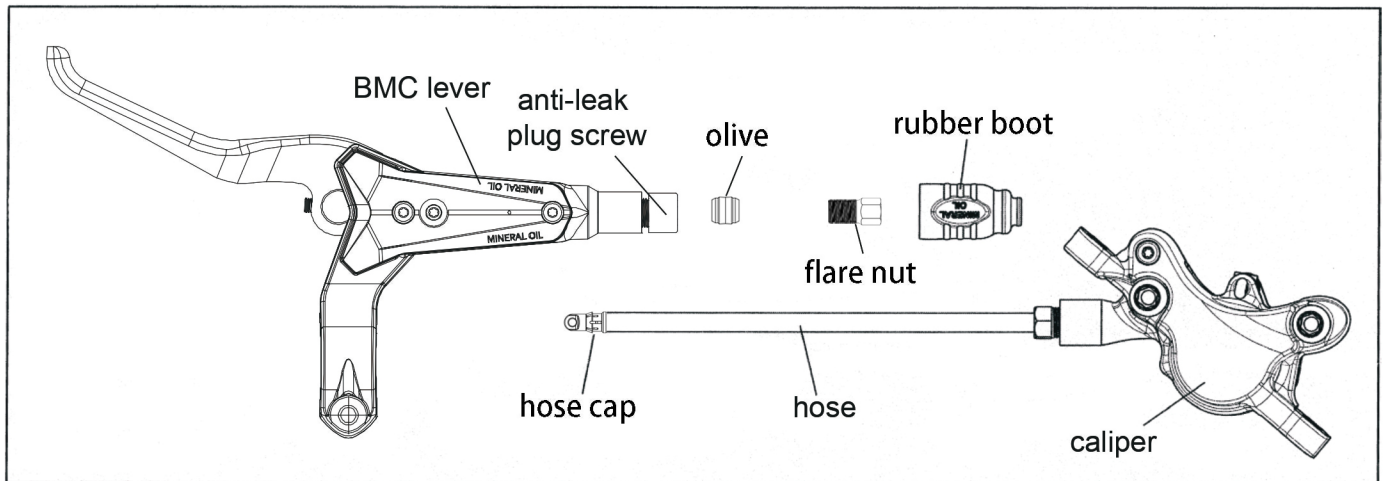

- ① Tool required
·1.5mm hex key ·M6 open-end wrench
- ② Use homing bead to help hose to thread through the inner tubes of frame (Fig. 1).
- ③ After hose was thread through, use 1.5mm hex key to remove the homing bead. Then unscrew the seal plug from BMC lever by using M6 open-end wrench (Fig. 2).

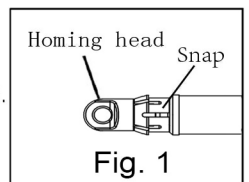

★Caution: When removing the guide head, check that the sealing balls in the guide head are removed together, because there are special cases where the sealing balls will be retained on the quick release pins after removing the guide head, so it is necessary to remove them manually to ensure that the oil pipe is free (Fig. 3)

★Caution: Do not swing hose after removing homing bead to avoid mineral oil leak.)

★Caution: Secure the hose connection port so that it is facing upward and do not pull brake lever to prevent mineral oil leak.)

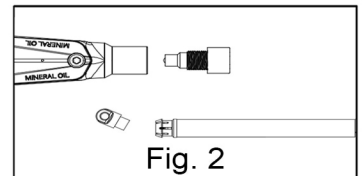

- ④ Install the rubber boot, flare bolt, and olive along the hose in order (Fig. 4)
★Caution: When the olive is inserted into the snap of the hose cap and the claw of snap is reset, there will be a slight “click” sound and a reset feeling. Both indicate that the olive has been installed in position. At this time, the olive can not be easily pulled out by normal force. Otherwise, the olive must be pulled out and re-inserted until it is confirmed to be in position.

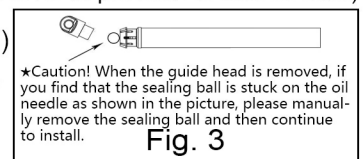

- ⑤ Insert hose into brake lever(Fig. 5)
- ⑥ Tighten the flare nut into the connection port (Torque 70-90 kgf-cm) (Fig. 6).

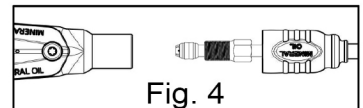

- ⑦ Install the rubber boot to finish the assembling process (Fig. 7).

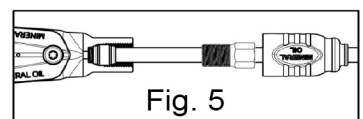

- ⑧ Checking methods after assembling:
 - (1) Ensure that the tightening torque of the flare nut is 70-90kgf-cm.
 - (2) Operate the brake lever 4-5 times until it feels back to normal.
 - (3) Depress the brake lever using about 6kg force and hold it for 30 seconds to check whether there is oil leak at the connection port and whether the reach distance is less than 1.5 fingers.
 - (4) If there occurs oil leakage at the connection port, please refer to the “I Series Assembly Instruction” manual and re-conduct the assembly process

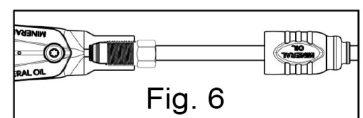

- (5) If the distance between brake lever and handle bar is less than 1.5 fingers, please add more oil to get it back to normal stiffness following the instructions in the manual.

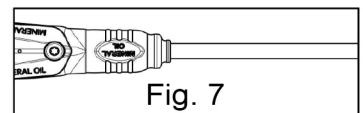

★Notice! In the process of disassembly and assembly of brake hose, if the operator is not skilled enough, the loss of certain amount of brake fluid would be inevitable, thereby results in a more loose hand feeling (Figs. 7A and B). When that occurs, more brake fluid should be added to ensure its return to normal stiffness according to corresponding operations in the manual (Fig. 8C). The instructions on brake fluid refueling in the Shimano dealer manual is also recommended.

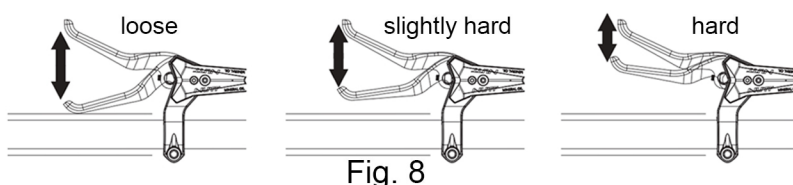

JK-SMS-Y2A-E002-B

LANXI JIEKE SPORTS APPARATUS
MANUFACTURING CO.,LTD.